

# Mould for straight outline cladding cut stones out of reconstituted limestone

size  
400x200x27mm

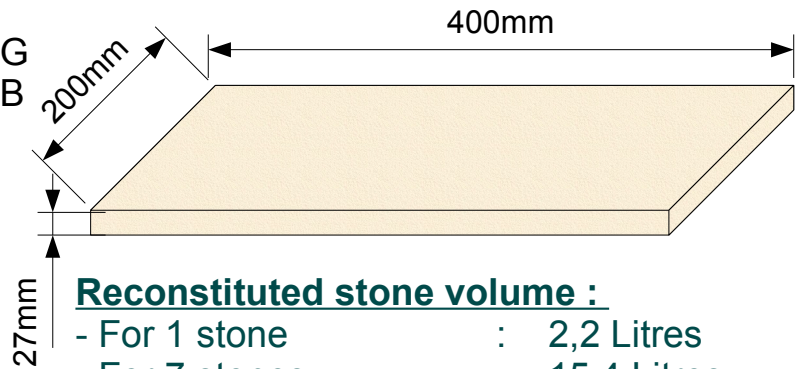
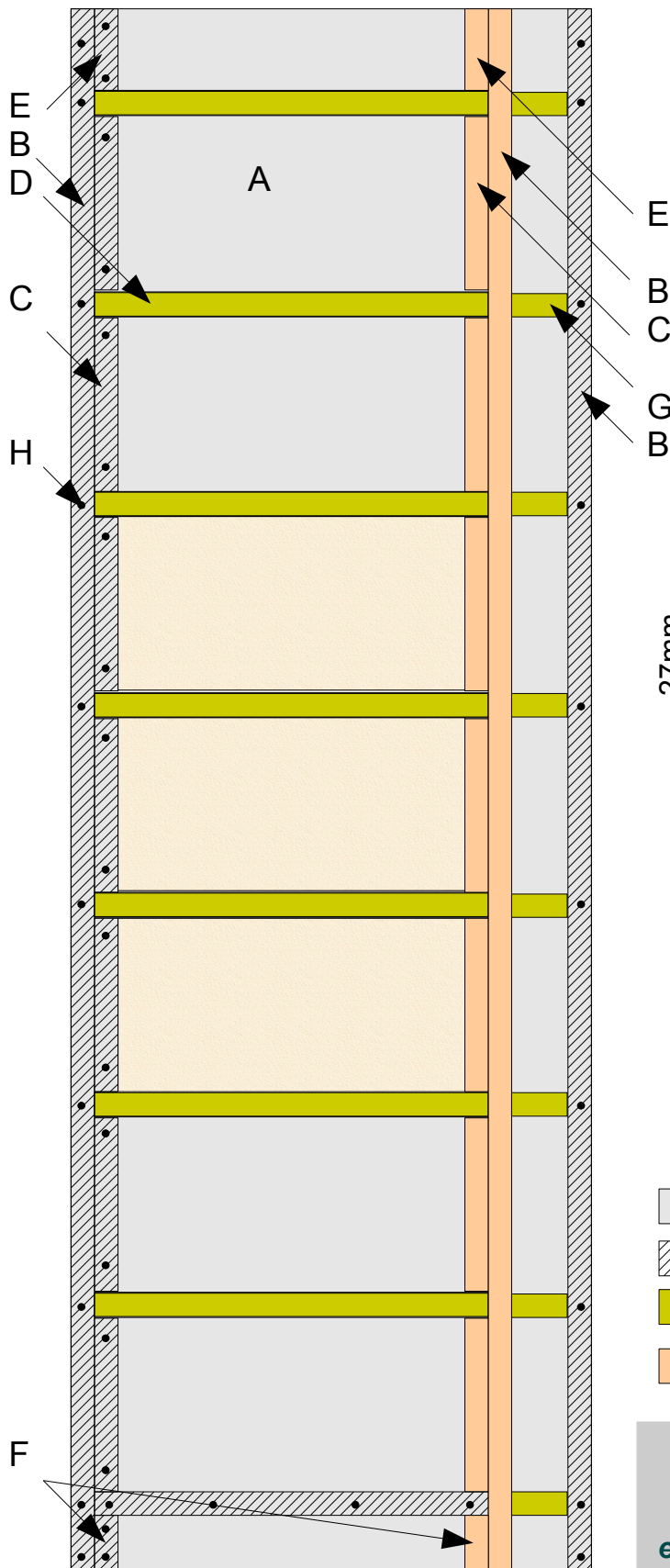

### Reconstituted stone volume :

- For 1 stone : 2,2 Litres
- For 7 stones : 15,4 Litres

### Weight of stones :

- For 1 stone : 4,8 Kg

### Fixing on existing wall :

With readily available tile adhesive for exterior or interior wall.

### Joints finishing :

Non-hydraulic lime mortar with mixing of washed and non-washed sand for a natural colouring.

- Base support
- Parts fixed on the base
- Mobile single parts
- Mobile parts assemblies

*The limestone mortar composition, the technique, the tricks, the fundamental cast stages and the finishing of the stone are explained in the Cut Limestone Moulder's Guide.*

**Author and drawing :** Loup de Saintonge  
**Contact :** [loup-de-saintonge@orange.fr](mailto:loup-de-saintonge@orange.fr)  
**Internet :** [www.my-caststone-dream.eu](http://www.my-caststone-dream.eu)  
**Page :** 1/4      **Ech :** 1/8

**Title :** Straight outline cladding stones 400x200x27mm  
**Subtitle :** Assembly view

**Plan :** plaque-reg-400x200x27 **Version :** V1 **Date :** 29/12/06

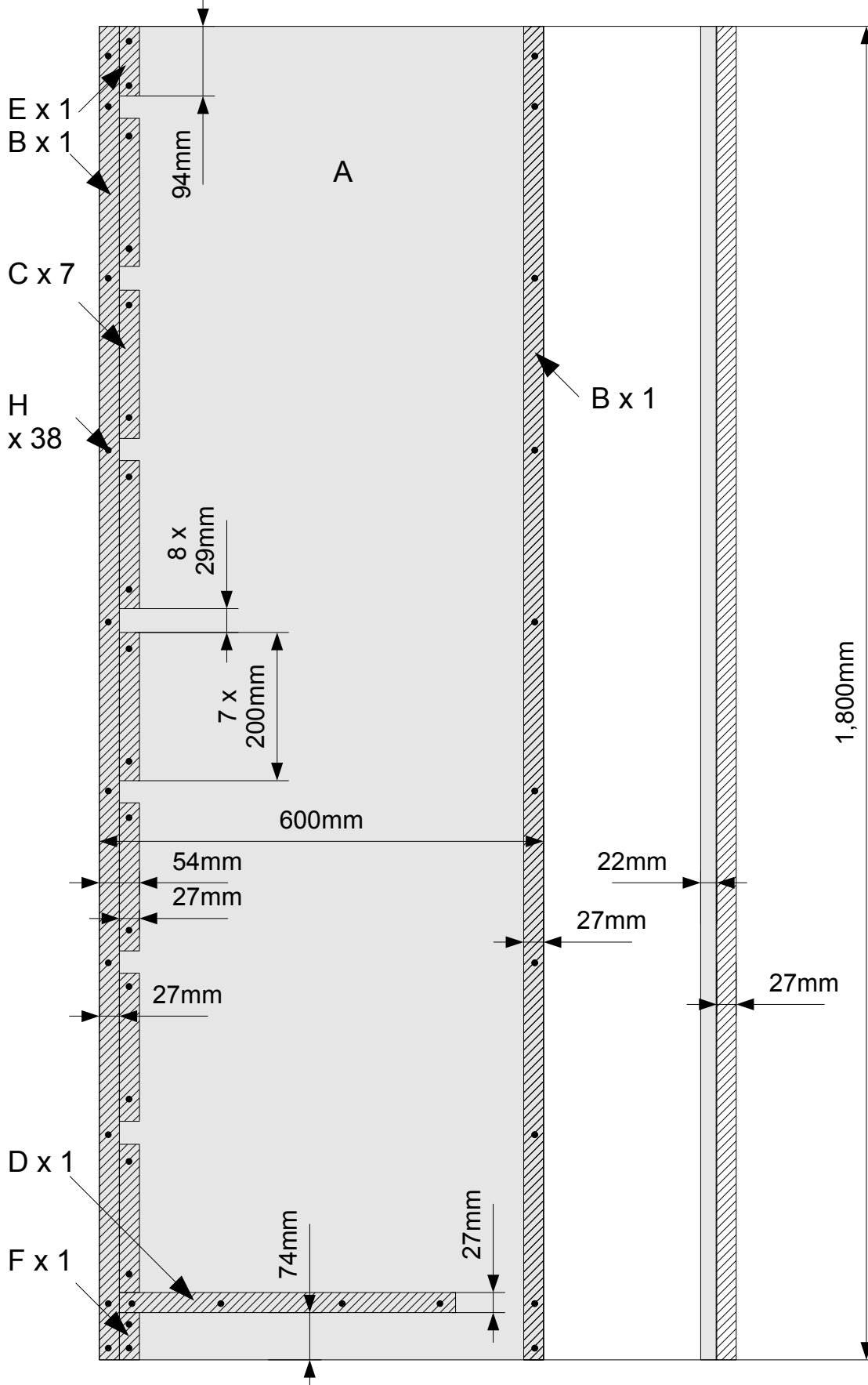

**Author and drawing :** Loup de Saintonge  
**Contact :** [loup-de-saintonge@orange.fr](mailto:loup-de-saintonge@orange.fr)  
**Internet :** [www.my-caststone-dream.eu](http://www.my-caststone-dream.eu)  
**Page :** 2/4      **Ech :** 1/8

**Title :** Straight outline cladding stones 400x200x27mm  
**Subtitle :** Support base assembling

**Plan :** plaque-reg-400x200x27 **Version :** V1      **Date :** 29/12/06

Copyright © Loup de Saintonge 2007 Registration INPI and Copyright France. Document protected in 163 countries by the Berne Convention and by the international laws for industrial and authors rights protection. Only the non-profit-making use by private individuals is authorized. Copy, diffusion, reproduction, professional use or profit-making prohibited without the author agreement. Consult the Web site for licences and royalties.

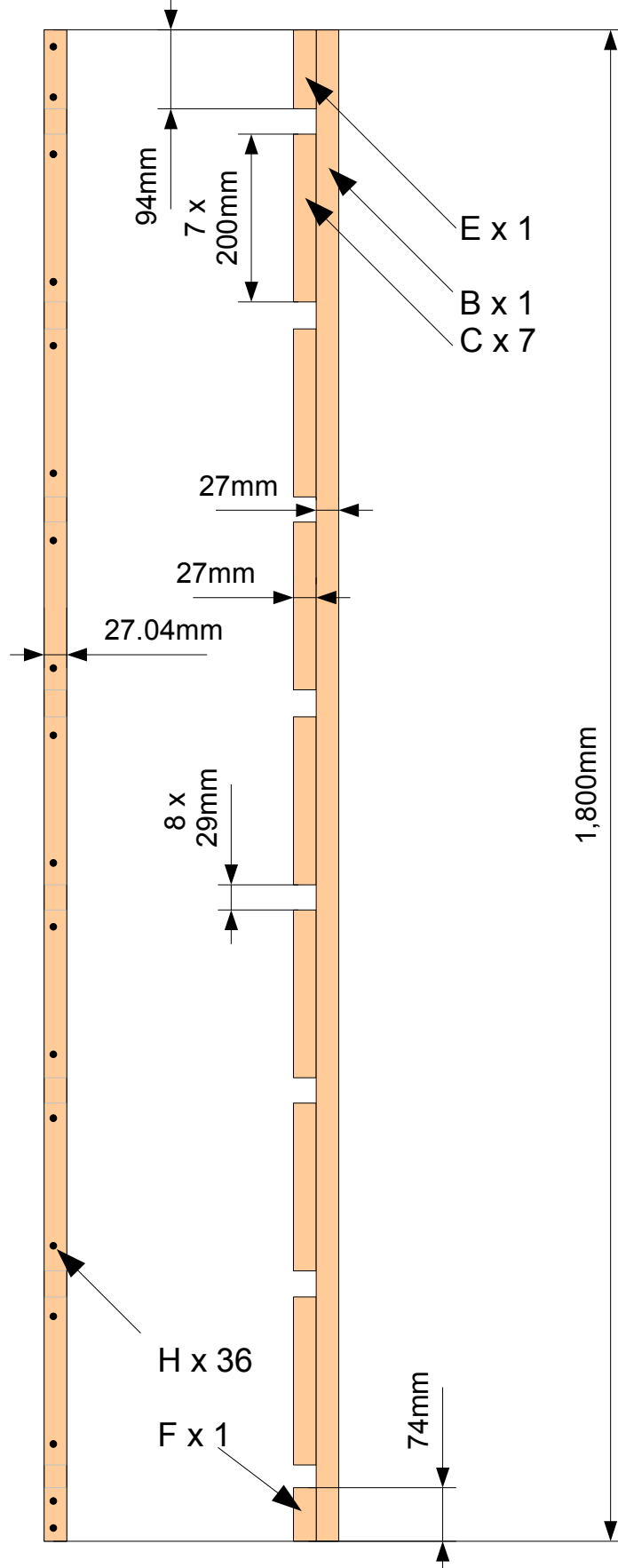

**Author and drawing :** Loup de Saintonge  
**Contact :** [loup-de-saintonge@orange.fr](mailto:loup-de-saintonge@orange.fr)  
**Internet :** [www.my-caststone-dream.eu](http://www.my-caststone-dream.eu)  
**Page :** 3/4      **Ech :** 1/8

**Title :** Straight outline cladding stones 400x200x27mm  
**Subtitle :** Complex mobile parts assembling

**Plan :** plaque-reg-400x200x27 **Version :** V1 **Date :** 29/12/06

Copyright © Loup de Saintonge 2007 Registration INPI and Copyright France. Document protected in 163 countries by the Berne Convention and by the international laws for industrial and authors rights protection. Only the non-profit-making use by private individuals is authorized. Copy, diffusion, reproduction, professional use or profit-making prohibited without the author agreement. Consult the Web site for licences and royalties.

<< 7 x D : Mobile elements lateral separators

<< 8 x G : Mobile elements, frontal stoppers

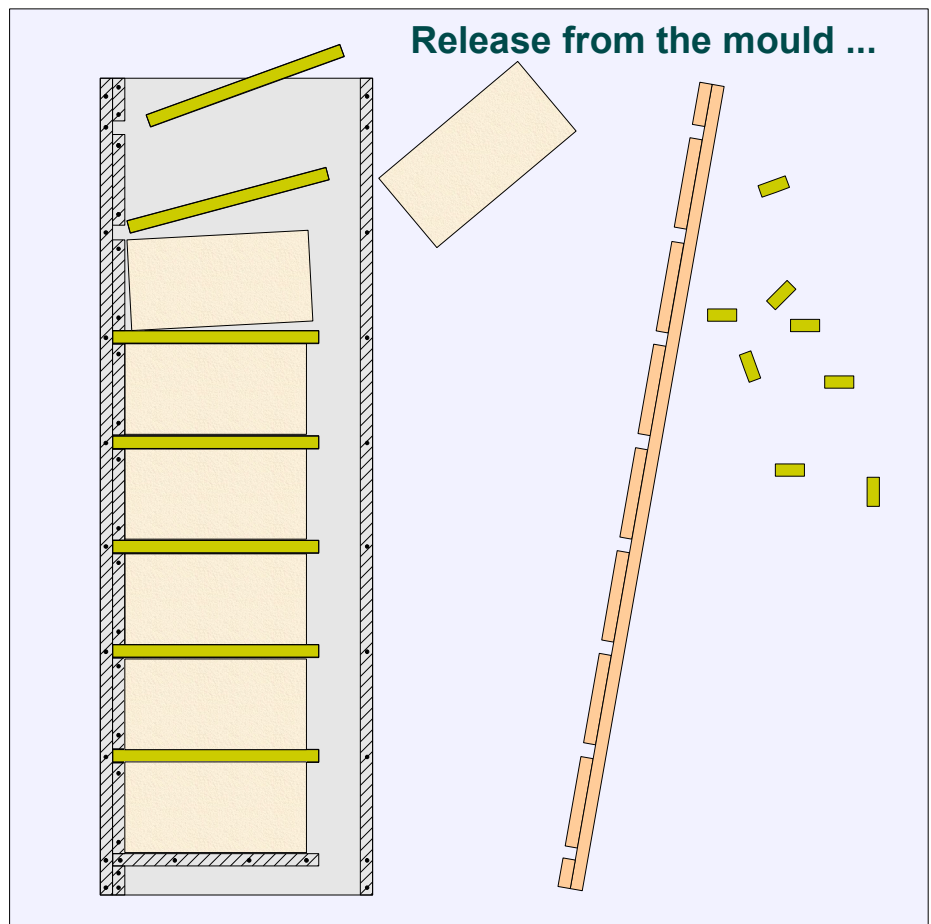
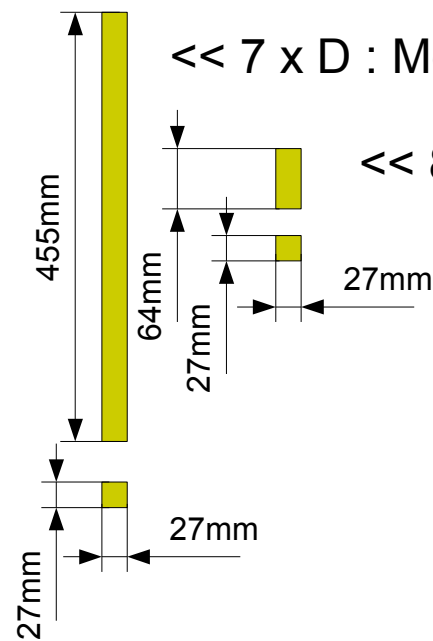

### Part list (bill of materials) :

- 1 x A = Board water-resistant agglomerated wood CTBH 600x1800x22mm (mould base)
- 3 x B = Fir rod 1800x27x27mm (2 fixed and 1 on mobile assembly)
- 14 x C = Fir rod 200x27x27mm (7 fixed and 7 on mobile assemblies)
- 8 x D = Fir rod 455x27x27mm (7 mobile and 1 fixed)
- 2 x E = Fir rod 94x27x27mm (1 on base and 1 on mobile assembly)
- 2 x F = Fir rod 74x27x27mm (1 on base and 1 on mobile assembly)
- 8 x G = Fir rod 64x27x27mm (mobile stoppers)
- 74 x H = Screws 45mm for agglomerated wood

**Cheap solution** : For the base, use a board of water-resistant agglomerated wood CTBH for flooring, available in do-it-yourself stores, in the size 600x1840x22mm.

**Author and drawing** : Loup de Saintonge  
**Contact** : [loup-de-saintonge@orange.fr](mailto:loup-de-saintonge@orange.fr)  
**Internet** : [www.my-caststone-dream.eu](http://www.my-caststone-dream.eu)  
**Page** : 4/4      **Ech** : 1/8

**Title** : Straight outline cladding stones 400x200x27mm  
**Subtitle** : Mobile elements and part list

**Plan** : plaque-reg-400x200x27 **Version** : V1      **Date** : 29/12/06

Copyright © Loup de Saintonge 2007 Registration INPI and Copyright France. Document protected in 163 countries by the Berne Convention and by the international laws for industrial and authors rights protection. Only the non-profit-making use by private individuals is authorized. Copy, diffusion, reproduction, professional use or profit-making prohibited without the author agreement. Consult the Web site for licences and royalties.